



US005493786A

United States Patent [19]

[11] Patent Number: **5,493,786**

Thomson

[45] Date of Patent: **Feb. 27, 1996**

[54] REAL ESTATE ELECTRO TAPE

[76] Inventor: **Christopher S. Thomson**, 9500 Seabrook Dr., NE., Albuquerque, N.M. 87111

3,908,281 9/1975 Fox .
4,586,150 4/1986 Budziak et al. 364/562
5,287,627 2/1994 Rando .

FOREIGN PATENT DOCUMENTS

55-63775 5/1980 Japan 33/1 P
WO89/10538 11/1989 WIPO 33/290

Primary Examiner—William A. Cuchlinski, Jr.
Assistant Examiner—G. Bradley Bennett
Attorney, Agent, or Firm—Michael I. Kroll

[21] Appl. No.: **370,519**

[22] Filed: **Jan. 9, 1995**

[51] Int. Cl.⁶ **G01B 7/02; G01B 11/02**

[52] U.S. Cl. **33/1 G; 33/784; 33/DIG. 21; 364/562**

[58] Field of Search 33/1 G, 1 P, 228, 33/275 R, 276, 277, 278, 279, 280, 285, 290, 292, 700, 760, 783, 784, 791, 792, 794, DIG. 21; 364/561, 562, 563, 564

[57] ABSTRACT

A real estate electro tape is provided that measures the length of an interior or exterior wall or other similar structure using optical means. A sonic tape is used to measure the perpendicular distance from the device to the interior or exterior wall. Two steerable lasers are then used to determine the angles between the perpendicular and the beams aimed at the wall edges. An algorithm is applied to the angular and perpendicular distance data to obtain the length of the wall. A microprocessor performs the calculations, the results of which are displayed on an electro optical display.

[56] References Cited

U.S. PATENT DOCUMENTS

572,816 10/1945 Wallis .
2,548,590 4/1951 Cook 33/791
3,590,704 6/1971 Endo 33/275 R
3,897,637 8/1975 Genho .

10 Claims, 2 Drawing Sheets

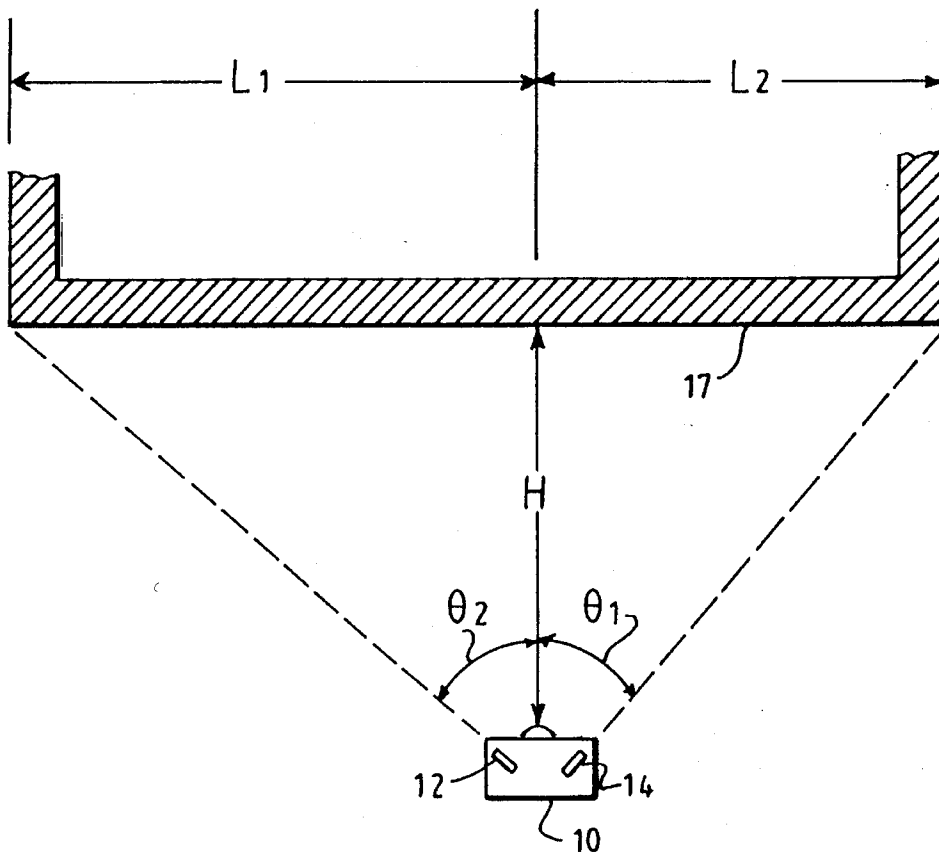

$$L_{TOTAL} = H \tan \theta_1 + H \tan \theta_2 + 2L'$$

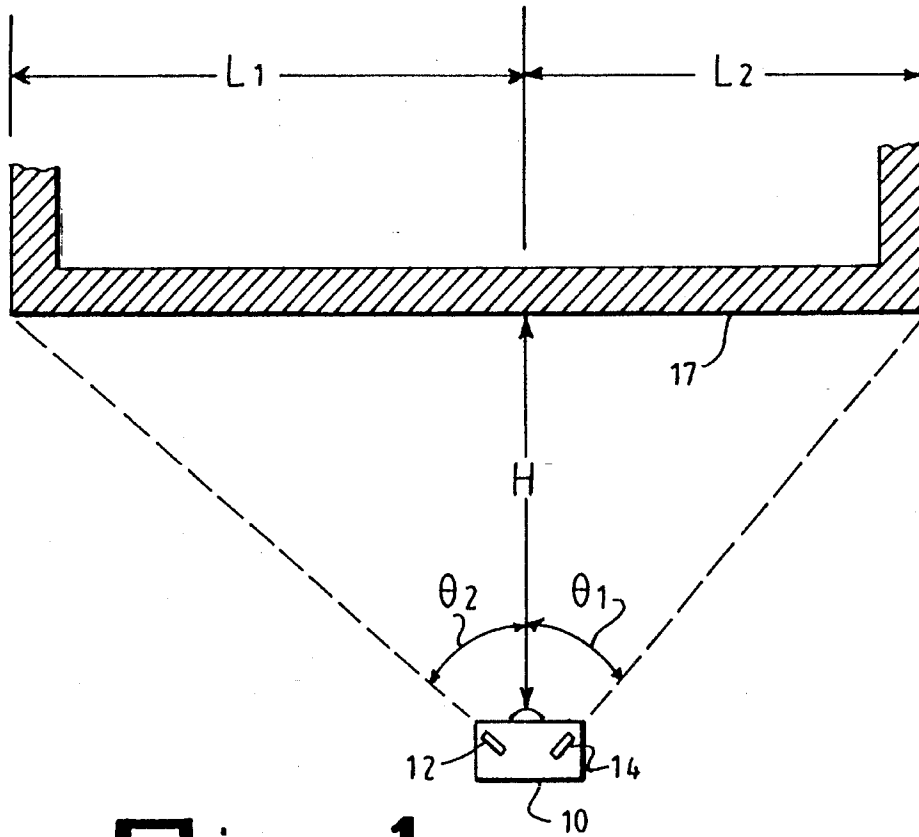

Fig. 1

$$L_{TOTAL} = H \tan \theta_1 + H \tan \theta_2 + 2L'$$

Fig. 2

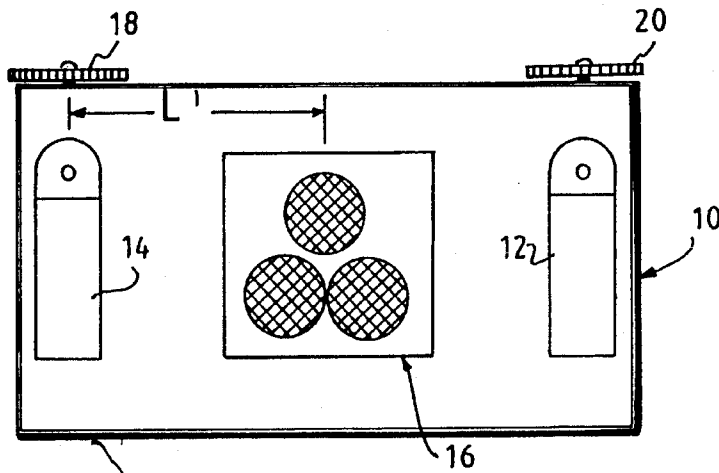

Fig. 3

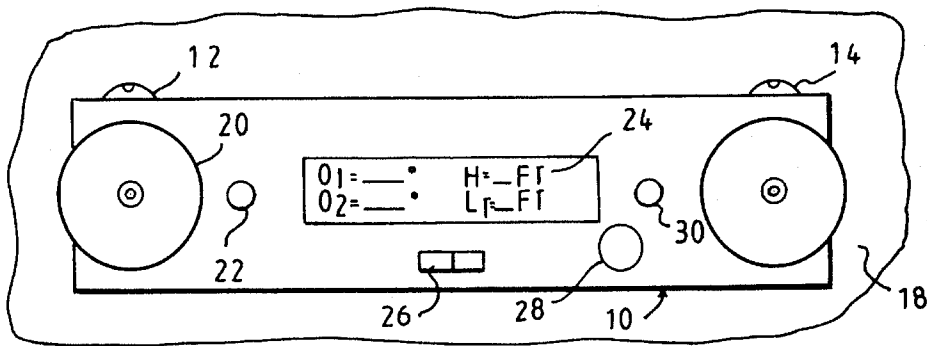

Fig. 4

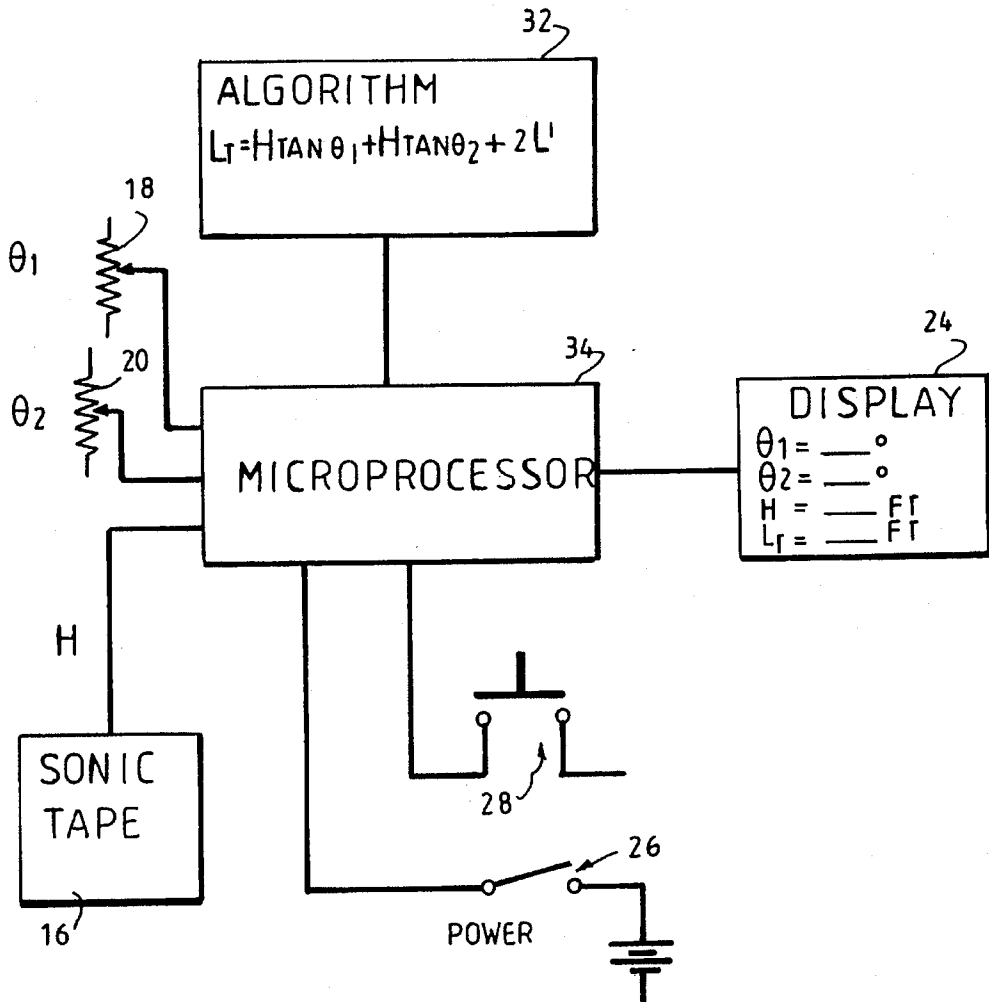

Fig. 5

REAL ESTATE ELECTRO TAPE

BACKGROUND OF THE INVENTION

The instant invention relates, generally, to the field of measurement instruments, and, more specifically, to devices that measure the length of an interior or exterior wall by indirect optical means.

In many fields of endeavor, such as real estate appraisal, architecture, engineering, and building inspection, it is necessary to measure the length of an interior or exterior wall. It is often difficult to get close enough to the wall to use, for instance, a measuring tape due to obstructions, vegetation, or jags in the direction of the wall.

A number of measuring solutions have been suggested. M. Fox (U.S. Pat. 3,908,281) suggests a real estate appraisal instrument and method. However, this instrument requires that an object of known dimension be observed and such an object is not always available. R. Genho (U.S. Pat. 3,897,637) proposes a laser level and square that does not provide any measuring means but merely provides a laser-generated line that defines a level. J. Rando (U.S. Pat. 5,287,627) provides an automatic plumb and level tool with acoustic measuring capability. This device is very useful in providing a means for measuring the distance to a laser-illuminated object but does not provide means for measuring the length of the object itself.

SUMMARY OF THE INVENTION

It is, therefore, a primary object of the present invention to provide a real estate electro tape that can be used to measure the length of an interior or exterior wall without direct contact with the wall.

A further object is to provide a real estate electro tape which uses optical methods to measure the length of an interior or exterior wall.

Another object is to provide a real estate electro tape which measures the length of an interior or exterior wall with a fairly high degree of accuracy.

A further object is to provide a real estate electro tape which measures the length of an interior or exterior wall quickly and with little training.

A further object is to provide a real estate electro tape which is simple and inexpensive to fabricate.

A yet further object is to provide a real estate electro tape that has an easy to read display.

To the accomplishment of the above and related objects, this invention may be embodied in the form illustrated in the accompanying drawings, attention being called to the fact, however, that the drawings are illustrative only and that changes may be made in the specific construction illustrated and described within the scope of the appended claims.

BRIEF DESCRIPTION OF THE DRAWING FIGURES

The figures in the drawings are briefly described as follows:

FIG. 1 is a diagrammatic view of the invention shown in use measuring the length of a wall.

FIG. 2 illustrates the algorithm used by the invention.

FIG. 3 is a front view of the invention.

FIG. 4 is a top view of the invention showing the controls and display thereof.

FIG. 5 is an electronic block diagram of the invention.

COMPONENT LIST

Reference	Description
10	REAL ESTATE ELECTRO TAPE
12	Steerable Laser #2
14	Steerable Laser #1
16	Sonic Tape
17	Wall to be Measured
18	Laser Steering Knob/Potentiometer #1
20	Laser Steering Knob/Potentiometer #2
22	Laser Locking/Release Button #2
24	Display
26	On/Off Power Switch
28	Calculate Button
30	Laser Locking Release Button #1
32	Algorithm Stored in Memory
34	Microprocessor

DETAILED DESCRIPTION OF THE PREFERRED EMBODIMENTS

FIG. 1 illustrates the real estate electro tape **10** in actual use. The wall to be measured is numeral **17**. In use, a sonic tape **16** is aimed at wall **17** to establish the distance between the invention **10** and the wall **17**. Sonic tape **16** is a conventional technology already in use and available from various sources. The output of the sonic tape **16** is the perpendicular distance (H) from the wall **17**. Next, steerable laser **12** is aimed at one corner of the wall. The user can confirm that the laser is hitting the edge or corner of the wall by observing the reflection of the laser. The beam from **12** makes an angle (θ_2) with the perpendicular. Similarly, steerable laser **14** is aimed at the opposite wall edge or corner to determine angle (θ_1). Note that θ_1 and θ_2 are typically not equal. Since the steerable lasers **12** and **14** are not exactly coincident with the sonic tape **16**, the displacement L' from sonic tape **16** must be taken into consideration. The total length of the wall **17** is determined, then, according to the following formula (see FIG. 2):

$$L_T = H \tan \theta_1 + H \tan \theta_2 + 2L'$$

The physical layout of the invention can best be understood with reference to FIGS. 3 and 4. Sonic tape **16** is centrally mounted on the front of **10**. Steerable lasers **12** and **14** are mounted at equal distances from sonic tape **16** and are mounted so as to allow the beams to scan in the horizontal plane. Laser steering knob/potentiometer **18** is used to adjust the horizontal position of steerable laser **14** and laser steering knob/potentiometer **20** is used to adjust the horizontal position of steerable laser **12**. The steering knobs are locked and released using laser locking/release buttons **22** and **30**. Power to **10** is turned on and off using on/off power switch **26**. When the distance measurement is desired, calculate button **28** is depressed causing information to be shown on display **24**.

The electronic operation of the invention is best understood with reference to FIG. 5. Microprocessor **34** processes data from a number of sources according to algorithm **32**. The inputs include: the output θ_1 of laser steering knob/potentiometer **18**, the output θ_2 of laser steering knob/potentiometer **20**, and the output H of sonic tape **16**. The output of microprocessor **34** is input to display **24**, which is typically a liquid crystal display (LCD) or a light emitting diode display (LED). The information displayed includes L_T and, optionally H, θ_1 , and θ_2 .

3

While certain novel features of this invention have been shown and described and are pointed out in the annexed claims, it will be understood that various omissions, substitutions and changes in the forms and the details of the device illustrated and in its operation can be made by those skilled in the art without departing from the spirit of the invention.

What is claimed is:

1. A real estate electro tape, comprising:

- a. a sonic tape wherein said sonic tape is a conventional ultrasonic laser ranging device whose output is the perpendicular distance (H) to a wall whose length is to be measured;
- b. a first steerable laser, mounted in close proximity to said sonic tape, wherein the light beam from said first steerable laser is aimed at one edge of said wall, such that the angle (θ_1) between said light beam and said perpendicular can be determined; and,
- c. a second steerable laser, mounted in close proximity to said sonic tape, wherein the light beam from said second steerable laser is aimed at the opposite edge of said wall, such that the angle (θ_2) between said light beam and said perpendicular can be determined; so that the total length of the wall, L_T , can be determined by the formula: $L_T = H \tan \theta_1 + H \tan \theta_2 + 2L'$ where L' is the distance, if any, between said sonic tape and each of said steerable lasers.

2. A real estate electro tape, as recited in claim 1, wherein said first and second steerable lasers have visible beams, and wherein said beams are aimed at corners or edges of said walls by observing the reflection of light off said corners when said steerable lasers are properly aimed.

3. A real estate electro tape, as recited in claim 1, further comprising calculating and display means for outputting said total length as determined by the formula: $L_T = H \tan \theta_1 + H \tan \theta_2 + 2L'$.

4. A real estate electro tape, as recited in claim 3, wherein said calculating means comprise:

4

- a. a potentiometer attached to said first steerable laser such that the output of said potentiometer is proportional to the angle between said first steerable laser and the perpendicular;
- b. a potentiometer attached to said second steerable laser such that the output of said potentiometer is proportional to the angle between said second steerable laser and the perpendicular;
- c. a memory containing the algorithm: $L_T = H \tan \theta_1 + H \tan \theta_2 + 2L'$; and,
- d. a microprocessor whose data inputs are the outputs of each of said potentiometers and the output of said sonic tape, wherein said microprocessor has as its output the total length L_T .

5. A real estate electro tape, as recited in claim 4, wherein said output of said microprocessor further comprises the perpendicular distance to the wall (H), the angle (θ_1) and the angle (θ_2).

6. A real estate electro tape, as recited in claim 3, wherein said display means comprises a liquid crystal display (LCD) showing at least total distance L_T .

7. A real estate electro tape, as recited in claim 3, wherein said display means comprises a light emitting diode display (LED) showing at least total distance L_T .

8. A real estate electro tape, as recited in claim 3, further comprising a power switch to turn said calculating and display means on and off.

9. A real estate electro tape, as recited in claim 3, further comprising a calculate button to reset said microprocessor and initiate processing according to said algorithm.

10. A real estate electro tape, as recited in claim 3, further comprising laser locking/release buttons, attached to each of said steerable lasers, such that said steerable lasers can be locked into any position and can only be adjusted when said locking/release buttons are in unlocked positions.

* * * * *